

BOARDROOMS

CURRAGH ROOM

LAYOUT	NUMBER
Boardroom	16
Dimensions in Feet	29' 8" x 11' 10"
Dimensions in Metres	9.2 x 3.75
Ceiling Height	2.6 m / 8' 5" ft

LEGEND	
	Telephone / ISDN
	Wireless Broadband
	Cupboard
	Screen
	Cassette Unit / AC
	Twin Socket

BOARDROOM

LAYOUT	NUMBER
Boardroom	14
Dimensions in Feet	26' x 13' 4"
Dimensions in Metres	7.9 x 4.1
Ceiling Height	2.6 m / 8' 5" ft

LEGEND	
	Telephone / ISDN
	Wireless Broadband
	Cupboard
	Screen
	Cassette Unit / AC
	Twin Socket

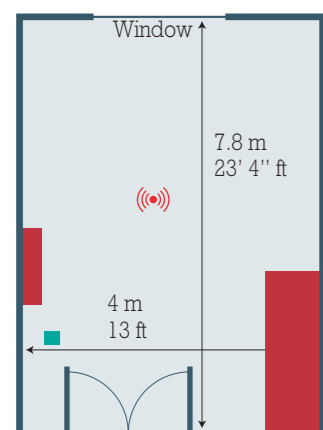
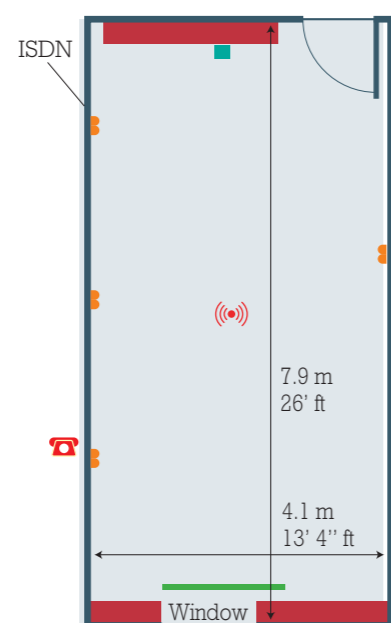

SYNDICATE ROOMS

LAYOUT	NUMBER
Boardroom	8
Dimensions in Feet	23' 4" x 13'
Dimensions in Metres	7.8 x 4
Ceiling Height	2.5 m / 12 ft

LEGEND	
	Wireless Broadband <i>Only available in the second floor syndicate</i>
	Cupboard
	Cassette Unit / AC

WEST WING

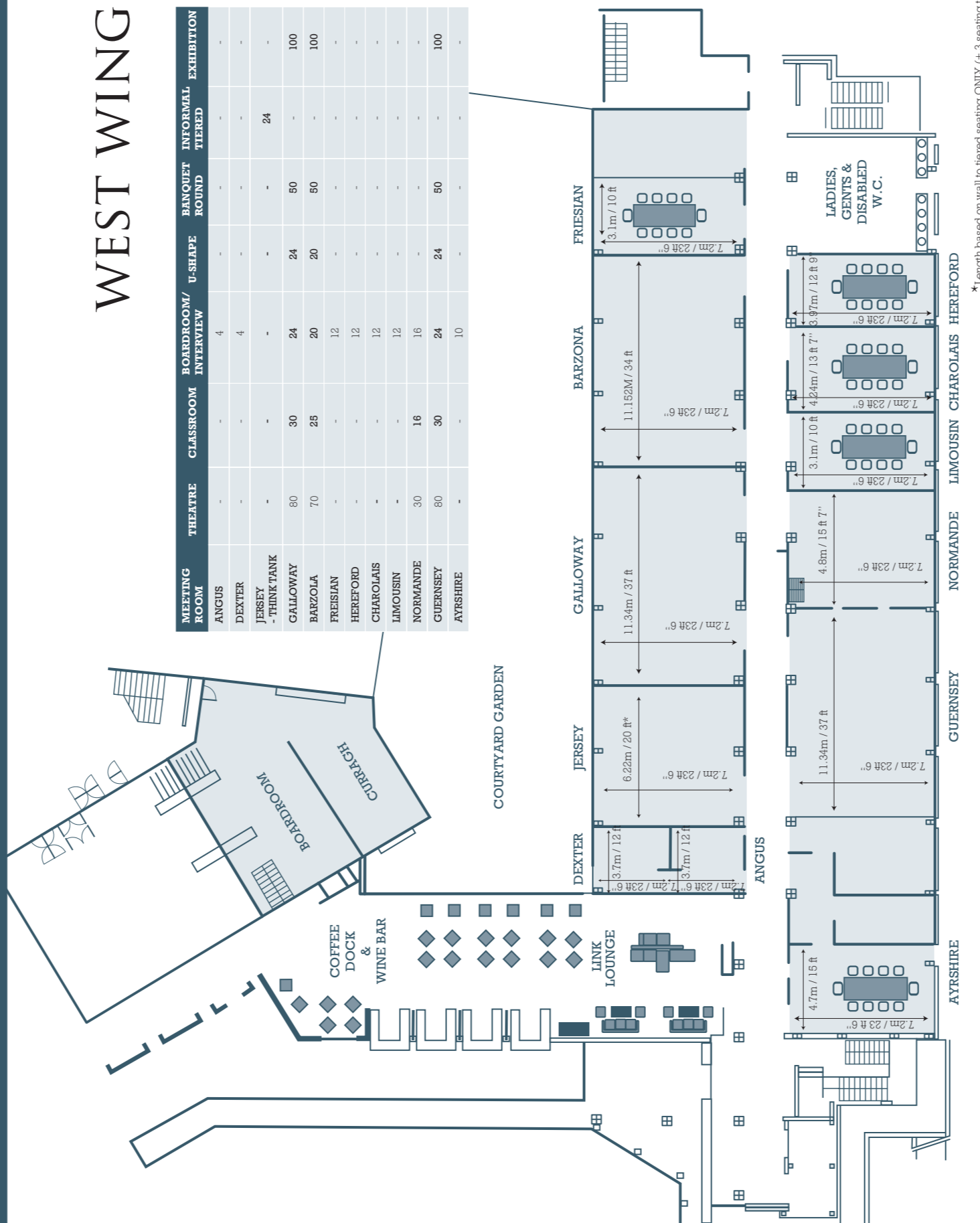

RED COW MORAN HOTEL COMPLEX LAYOUT & FLOOR PLANS

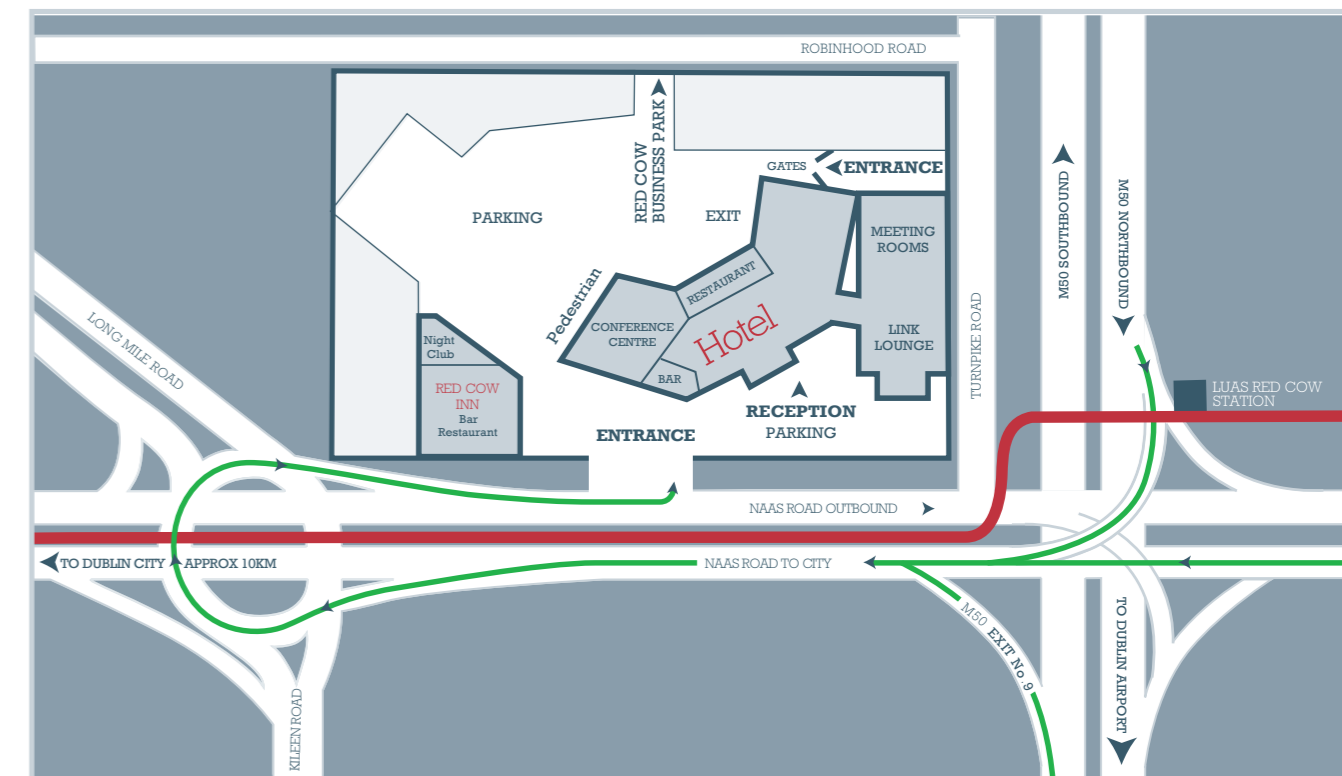

LEGEND	
	Luas Line
	Luas Station
	Road
	M50
	Dublin Airport

The hotel is situated beside the junction of the N7 (Naas Road) and the M50.

Conveniently located for easy access to Dublin international airport and main thoroughfares to Cork, Limerick and Waterford.

The Luas Red Cow station also allows quick and easy access to and from Dublin city centre

CONFERENCE SUITE

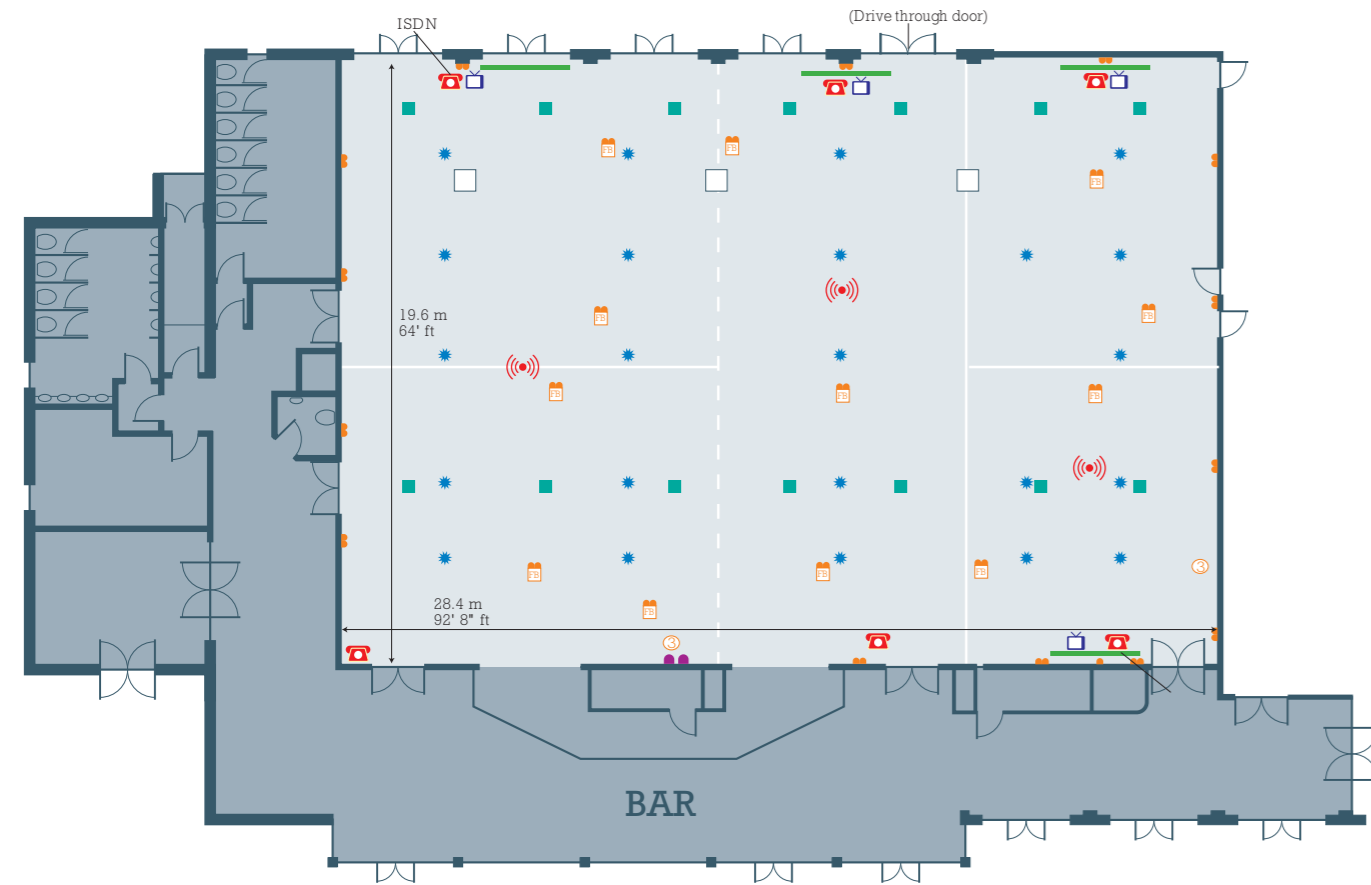

LEGEND	
	Telephone / ISDN
	Wireless Broadband Internet Access
	Television Outlet
	Speaker
	Cassette Unit / AC
	Twin Socket
	Single Socket
	3 Phase 380volt 63amp
	Floorbox
	63A SP+N Socket
	Automatic Roll Down Screens

LAYOUT	NUMBER
Theatre	720
Classroom	350
U-Shape	150
Lunch/Dinner	550
Cocktail Reception	800
Dimensions in Feet 64' x 92' 8"	
Dimensions in Metres 19.6 x 28' 4"	
Ceiling Height 3.25 m / 10' 8" ft	
Door Height 2.7m	

MERRION SUITE

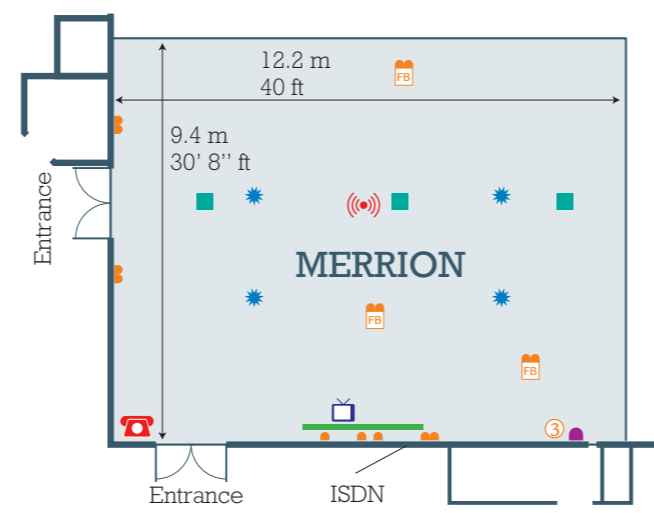

LAYOUT	NUMBER	LEGEND
Theatre	120	Telephone / ISDN
Classroom	50	Wireless Broadband
U-Shape	35	Television Outlet
Boardroom	35	Speaker
Lunch/Dinner	80	Cassette Unit / AC
Cocktail Reception	175	Twin Socket
Dimensions in Feet 30' 8" x 40'		
Dimensions in Metres 9.4 x 12.2		
Ceiling Height 3.25 m / 10' 8" ft		

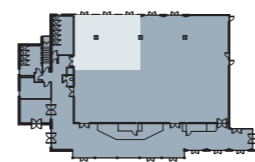

O'CONNELL SUITE

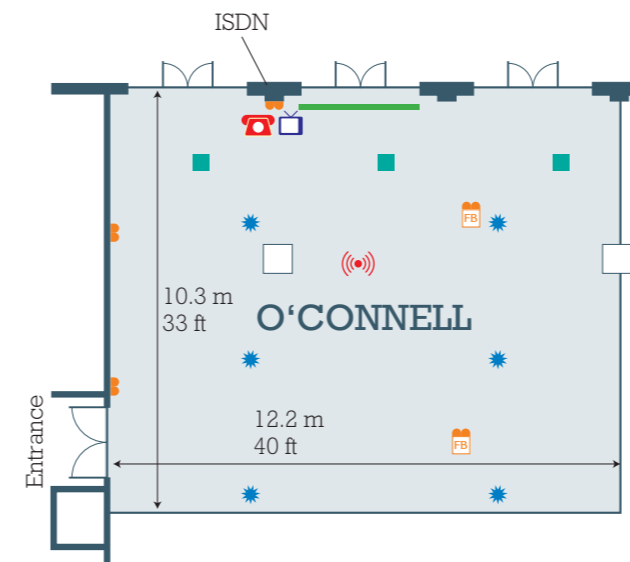

LAYOUT	NUMBER	LEGEND
Theatre	120	Telephone / ISDN
Classroom	50	Wireless Broadband
U-Shape	35	Television Outlet
Boardroom	35	Speaker
Lunch/Dinner	80	Cassette Unit / AC
Cocktail Reception	175	Twin Socket
Dimensions in Feet 33' x 40'		
Dimensions in Metres 10.3 x 12.2		
Ceiling Height 3.25 m / 10' 8" ft		

MERRION & O'CONNELL SUITE

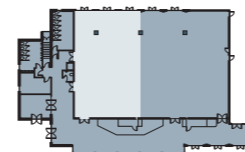

LAYOUT	NUMBER
Lunch/Dinner	180
Cocktail Reception	350

PARNELL SUITE

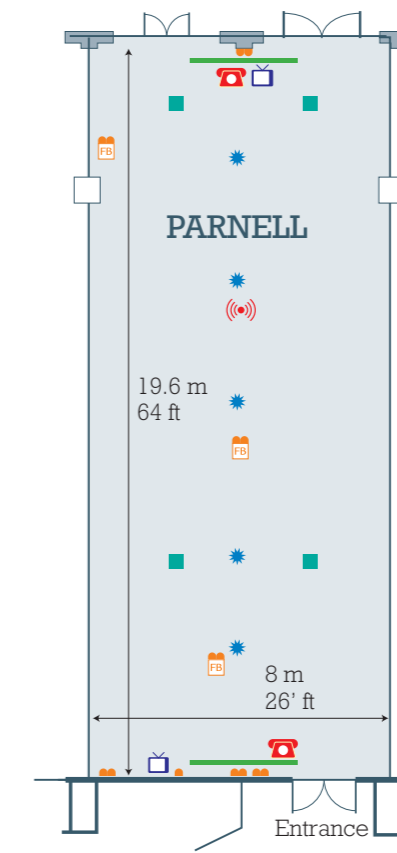

LAYOUT	NUMBER	LEGEND
Theatre	180	Telephone / ISDN
Classroom	80	Wireless Broadband
U-Shape	40	Television Outlet
Boardroom	50	Speaker
Lunch/Dinner	100	Cassette Unit / AC
Cocktail Reception	200	Twin Socket
Dimensions in Feet 64' x 26'		
Dimensions in Metres 19.6 x 8		
Ceiling Height 3.25 m / 10' 8" ft		

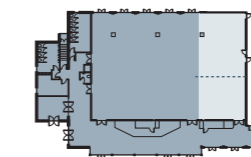

PEARSE SUITE

LAYOUT	NUMBER	LEGEND
Theatre	180	Telephone / ISDN
Classroom	80	Wireless Broadband
U-Shape	40	Television Outlet
Boardroom	50	Speaker
Lunch/Dinner	100	Cassette Unit / AC
Cocktail Reception	200	Twin Socket
Dimensions in Feet 64' x 26'		
Dimensions in Metres 19.6 x 8		
Ceiling Height 3.25 m / 10' 8" ft		

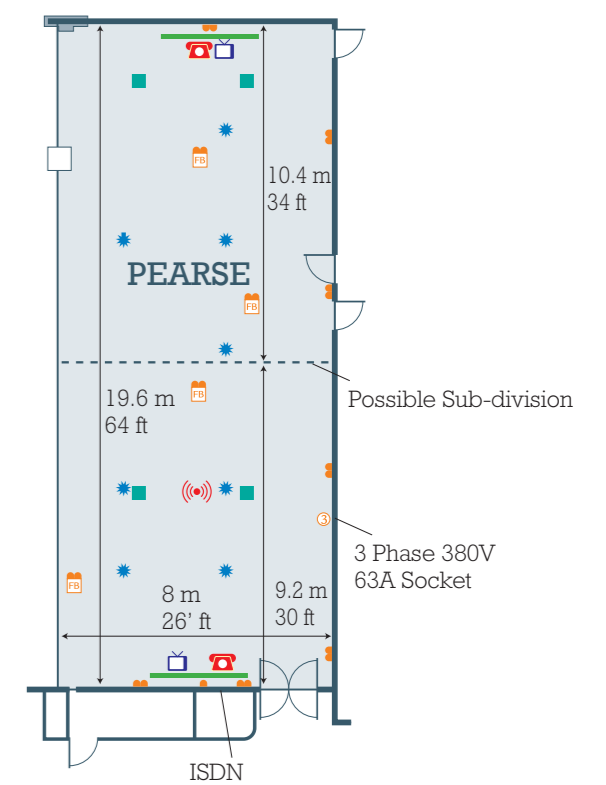

PARNELL & PEARSE SUITE

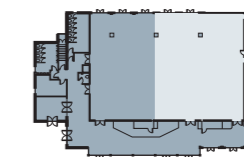

LAYOUT	NUMBER
Lunch/Dinner	180
Cocktail Reception	350